

■ AMPM-LED

■ LED Aiming Point Light

## Compliance with Standards

CAAC:AC-137-CA-2017-01-R1  
 SAC: GB/T 7256  
 ICAO: Annex 14, Volume II  
 FAA: AC 150/5345-46 & EB NO.87

## Application/Use

LED Aiming Point Light of Heliport

## Features

- Long working life LED, energy conversation, maintenance-free, which brings enormous economic benefits to customers;
- Special designed LED lens is adopted to greatly improve LED light efficiency;
- Patented prism structural design and manufacturing process to ensure excellent optical performance;
- Strict LED color management to ensure the consistency of light color;
- High reliability electronic components to match LED as long as possible;
- Bevel design of prism to prevent snow accumulation;
- Frangible parts are processed by high precision machine tools, T6 heat treatment to ensure stable performance;
- Main structure is made of corrosion-resistant aluminum alloy with electrostatic powder coating, all fasteners are made of stainless steel, suitable for harsh environment application;
- Consistent dimming curve to comply with FAA standard;
- The main body of the light fittings is designed with sealing, long service life, simple and safe maintenance.

## Structure

- 1.Upper cover
- 2.Prism gasket sleeve
- 3.Prism
- 4.Light body gasket
- 5.Prism gasket
- 6.LED lamp assy lens
- 7.LED lamp assy
- 8.Prism pressing bracket
- 9.Driver
- 10.transformer
- 11.Light body
- 12.A6 Plug

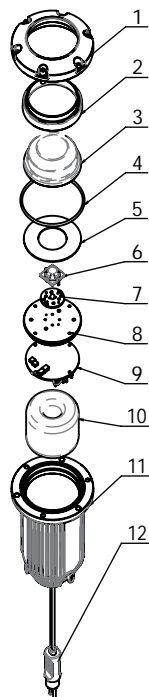

## Ordering Information

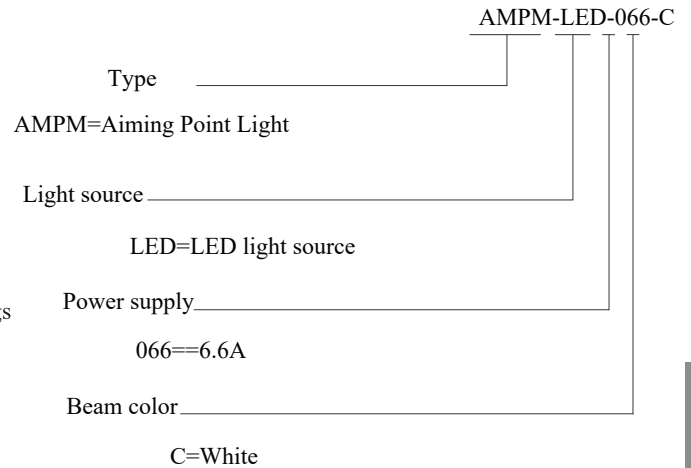

\* Please provide detailed installation info while ordering, spare parts and accessories should be separately ordered with specific order no.

## Installation

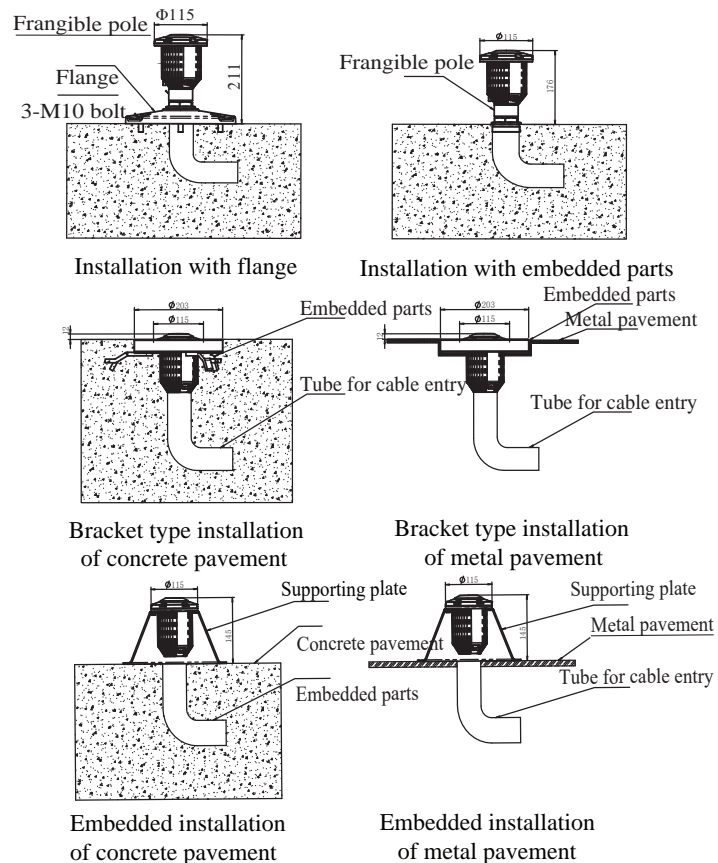

\* Please find detailed information in installation manual

■ AMPM-LED

■ LED Aiming Point Light

## Specifications

Light source: one White LED particle  
Power : 22 VA  
IP Grade: IP65

## Photometric Data

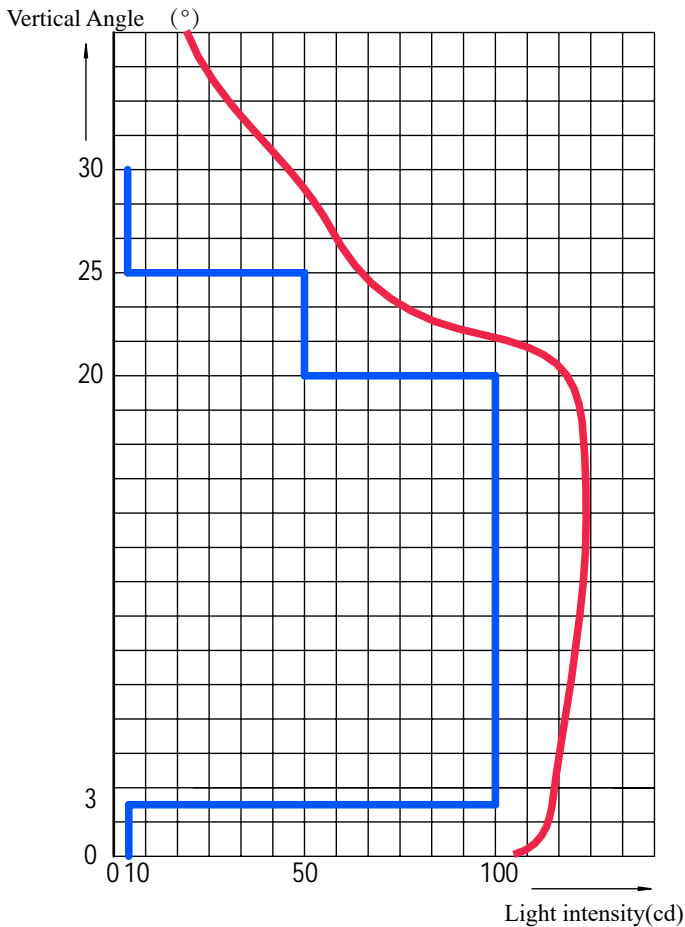

LED aiming point light (white),  
AC-137-CA chapter 5.2.1.6  
(vertical coverage of main beam 0° - 30°)

Application		Main Bean		Color	Required Min.	Actual Min.
		H	V			
AMPM	AC-137-CA 5.2.1.6	360°	0°- 3°	white	10	130
		360°	3°-20°	white	100	162
		360°	20°-25°	white	50	50
		360°	25°-30°	white	10	40

## Spare Parts

Struc No	Part Name	Order No	Description
2	Prism gasket sleeve	43115	LED omni- prism gasket sleeve
3	Prism	31113	Omni- prism (LED3-20°) 52°
4	Light body gasket	41187	O-ring 85×2.65
5	Prism pressing gasket	43311	Prism gasket 81
7	LED lamp assy	79263	LED white
9	Driver	79133	6.6A
10	Transformer	ITF-025-066	25W
12	A6 plug	70602	M12

## Accessories

No	Order No	Description
1	PLG6	A7 two core socket (assembly) - flat 1130
2	FL-10	Flange 240
3	54101	Hexagonal wrench for frangible pole of elevated lighting fixture
4	924231	Frangible Pole (HX)
5	4660X	Supporting plate 255x118
6	60905	Embedded parts 203

## Packing Data

Packaging: 4pc/box  
Net weight: 1.3 KG/box  
Gross weight: 5.2 KG/box  
Volume: 300\*255\*380 mm<sup>3</sup>

\* All rights reserved, subject to modifications

FPAGM-LED

2  
2