

■ TLOFS-LED

■ LED Inset Touchdown and Lift-off Area Perimeter Light



Compliance with Standards

CAAC:AC-137-CA-2017-01-R1
 SAC: GB/T 7256
 ICAO: Annex 14, Volume II
 IEC: TS61827
 FAA: AC 150/5345-46 & EB NO.87
 ICAO: Aerodrome Design Manual- Part 4

Application/Use

Inset Touchdown and Lift-off Area Perimeter Light of Heliport

Features

- Long working life LED, energy conversation, maintenance-free, which brings enormous economic benefits to customers;
- Special designed LED lens is adopted to greatly improve LED light efficiency;
- Patented prism structural design and manufacturing process to ensure excellent optical performance;
- Strict LED color management to ensure the consistency of light color;
- Consisting dimming curve to comply with FAA standard;
- Patented drive circuit and thermal management scheme greatly improve the reliability and service life of lighting fixtures;
- Power factor above 0.9, minimizing the grid interference;
- Interchangeable, modular-designed components, applicable for all series of 8-inch LED in-pavement omnidirectional lights;
- Specially designed structure, protrusion over pavement is less than 6.3mm;
- Upper cover with flat out-light surface to prevent water from building up and ensure high luminous efficiency;
- Main structure made of corrosion-resistant aluminum alloy with special anodizing treatment, all fasteners are made of stainless steel, suitable for harsh environment application;
- IP67 Ingress protection-grade, that can withstand inner pressure of up to 138kpa or water pressure generated from aircrafts' impact on the optical window.

Structure

1. Upper cover
2. Lighting fixture gasket
3. Prism
4. Prism gasket sleeve
5. Prism gasket
6. LED lamp assembly
7. Prism pressing bracket
8. Light body gasket
9. Inner cover assembly

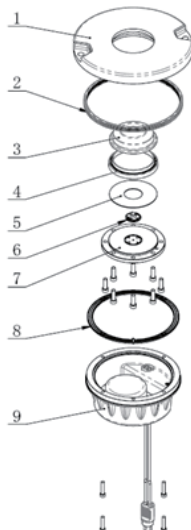

Ordering Information

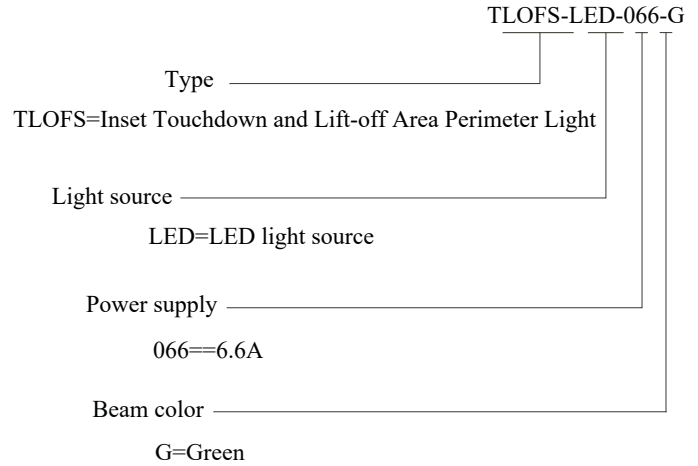

* Please provide detailed installation info while ordering, spare parts and accessories should be separately ordered with specific order no.

Installation

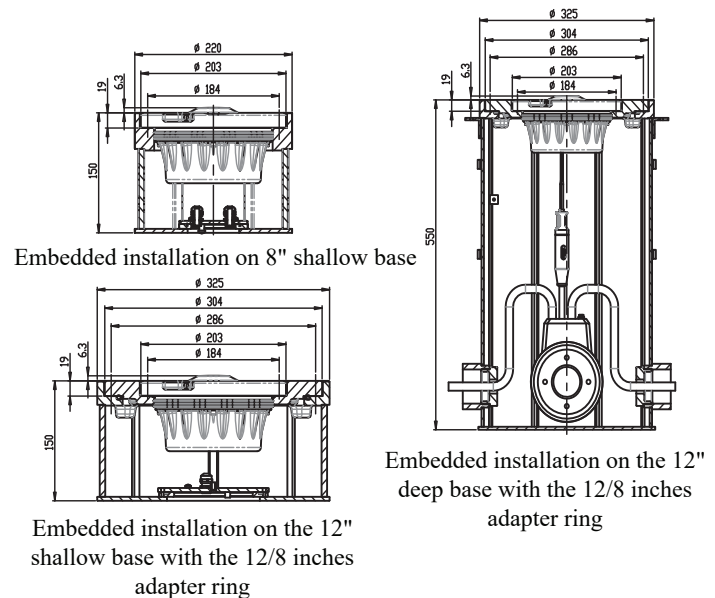

* Please find detailed information in installation manual

TL0FS-LED

LED Inset Touchdown and Lift-off Area Perimeter Light

Specifications

Light source: one Green LED particle
 Power : 14 VA
 IP Grade: IP67

Photometric Data

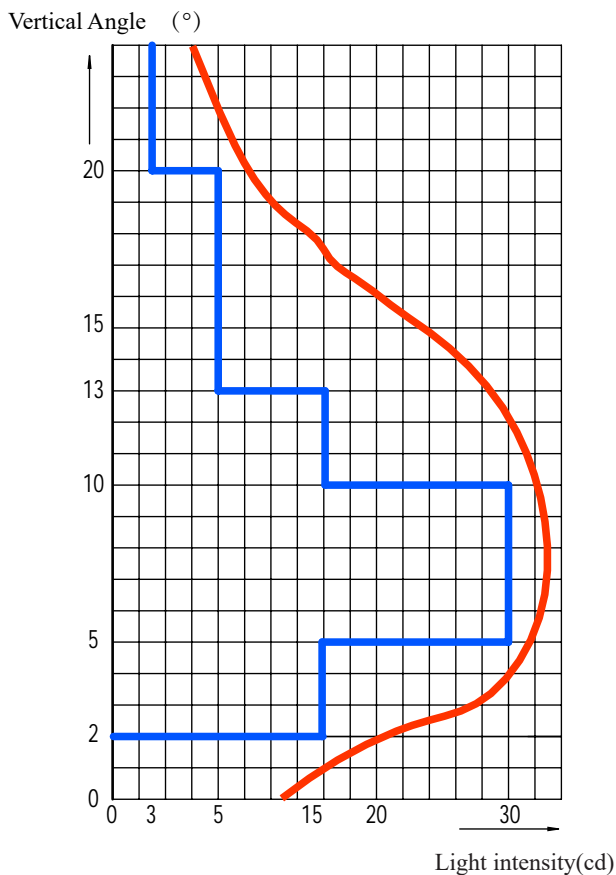

LED Inset Touchdown and Lift-off Area Perimeter
 Light of heliport(green), AC-137-CA chapter 5.2.1.7
 (vertical coverage of main beam 0° - 90°)

Application		Main Beam		Color	Required Min.	Actual Min.
		H	V			
TLOFS	AC-137-CA 5.2.1.7	360°	2°- 5°	green	15	34
		360°	5°-10°	green	30	36
		360°	10°-13°	green	15	38
		360°	13°-20°	green	5	18
		360°	20°-90°	green	3	6

Spare Parts

Struc No	Part Name	Order No	Description
2	Light gasket	41107	Sealing tape (standard)
3	Prism	31113	Omni- prism (LED1-6°)
4	Prism gasket sleeve	43115	Prism gasket sleeve
5	Prism gasket	43313	Prism gasket 66x51
6	LED lamp assy	79245-G	LED green
7	Prism pressing bracket	43217	Prism pressing bracket 108
8	Light body gasket	41141	Gasket 137x2
9	Inner cover assy	921251	6.6A

Accessories

No	Order No	Description
1	SB-08	Shallow base (8-inch)
2	SB-12	Shallow base (12-inch)
3	DB-12	Deep base (12-inch)
4	AR/12-08	Adaptor ring 12-8
5	951101	Lamp holder of 8-inch light
6	ITF	Isolation transformer
7	REC-7	Secondary cable connector style 7
8	95111-T	Base mounting bracket (telescope version)

Packing Data

Packaging: 1pc/box
 Gross weight: 3.0 KG/box
 Volume: 210*210*130 mm³

Packaging: 1pc/box (with 8-inch base)
 Gross weight: 6.0 KG/box
 Volume: 250*250*185 mm³

* All rights reserved, subject to modifications